

J.B. CONCRETE PRODUCTS, INC.

7' SQUARE-TAPERED LIGHT POLE BASE

DATE:
March 16, 2017
Drawing I.D.
L.P.B._SQTAP

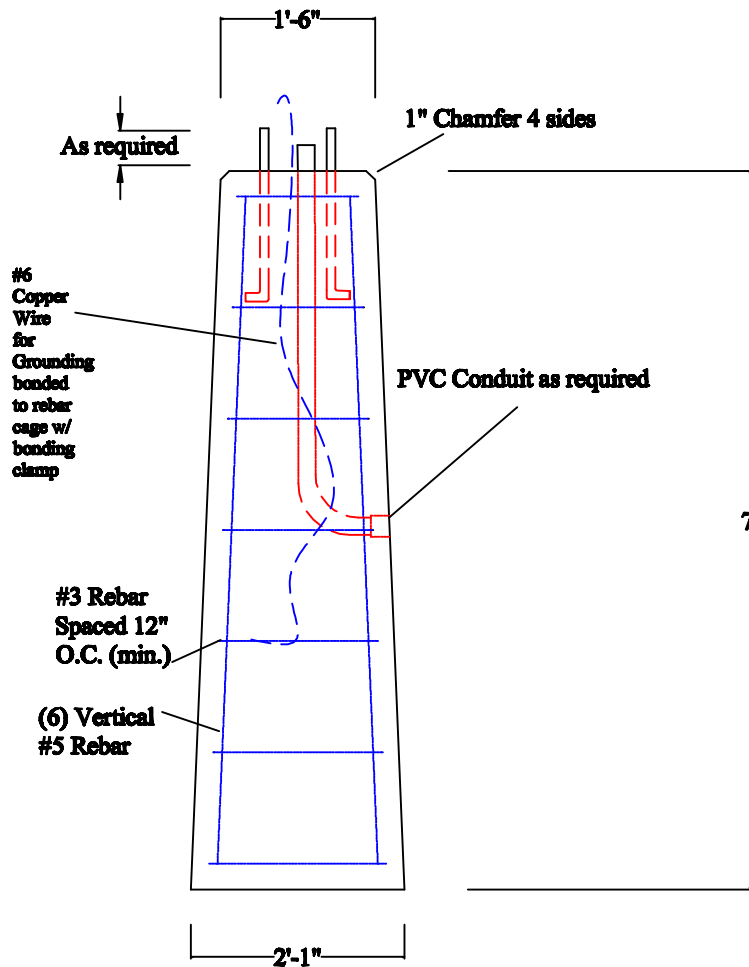
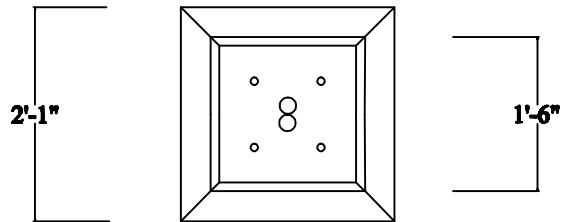

Notes:

- 1..PVC CONDUIT SIZE AND LOCATION AS REQUIRED.
2. ANCHOR BOLTS AND LAYOUT SUPPLIED BY CONTRACTOR
3. MINIMUM CONCRETE COMPRESSION STRENGTH 5,000 PSI AFTER 28 DAYS.
4. ORDERS COMPLETED IN ACCORDANCE TO LIGHT POLE BASE SUBMITTAL FORM AND ENGINEER SPECS.
5. STEEL REINFORCEMENT COMPRISED OF GRADE-60 REBAR TO CONFORM TO DESIGN SPEC
6. 6 GA. COATED GROUND WIRE CAST INTO BASE PROTRUDING AT TOP AND BONDED TO REBAR WITH COPPER BONDING CLAMP.

1 Arch St
PO Box 387
Putnam, CT 06260
(860)928-9365
F (860)928-9452
www.jbconcreteproducts.com