

J.B. CONCRETE PRODUCTS, INC.

DB9 - 9 OUTLET DISTRIBUTION BOX

DATE:
Sept. 20, 2015
Drawing I.D.
DB9

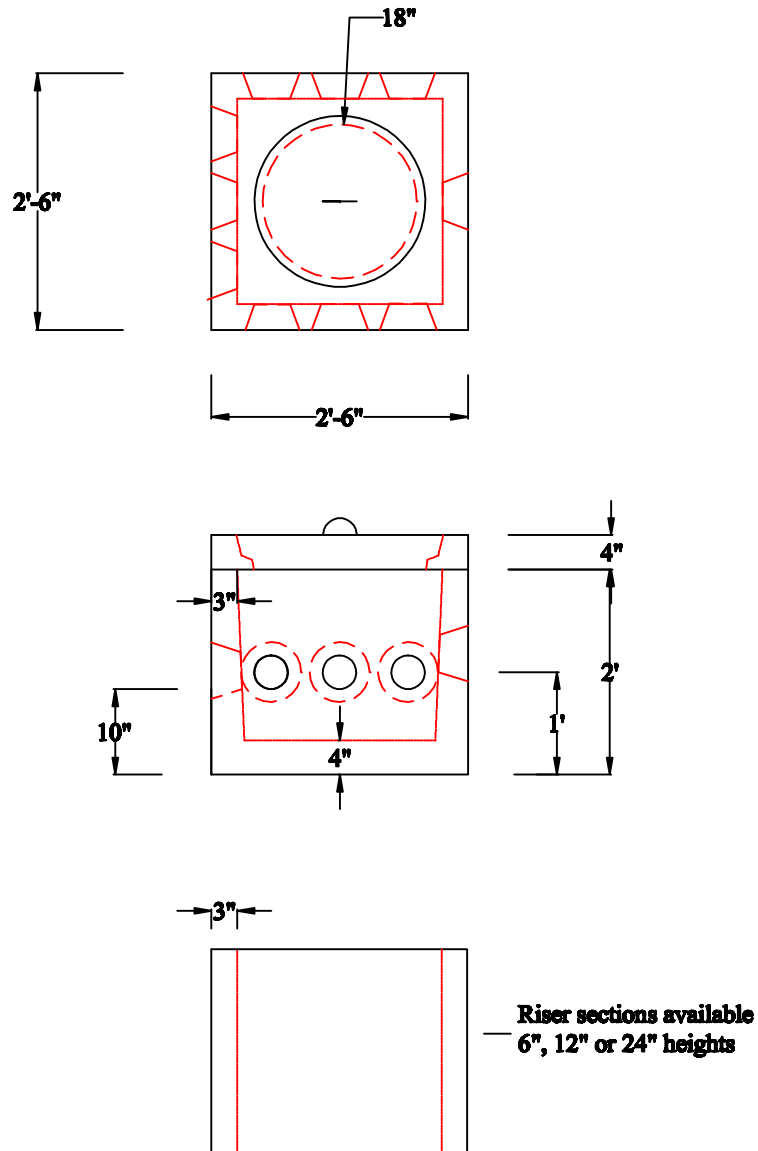

Notes:

1. STATE APPROVED INLET AND OUTLET PIPE SEALS
2. 9 OUTLETS(4") AND 1 INLET(4")
3. MINIMUM CONCRETE COMPRESSION STRENGTH 5,000 PSI AFTER 28 DAYS.
4. MEETS H20 WHEEL LOADING.

1 Arch St
PO Box 387
Putnam, CT 06260
(860)928-9365
F (860)928-9452
www.jbconcreteproducts.com